



**LEGEND**

- Benches (8 total)
- Interpretive signs (11 total)
- Pedestrian lighting (+/- 50' OC)
- Exercise stations (5 total)

**Corvus Design**  
Landscape Architecture  
www.corvus-design.com  
Anchorage - 907.222.2859  
Juneau - 907.988.9000  
119 Seward St, 99801  
AECC #1195

**CITY AND BOROUGH OF JUNEAU**  
ALASKA'S CAPITAL CITY  
ENGINEERING & PUBLIC WORKS

SEAL:

City and Borough of Juneau  
**Riverside Rotary Park**  
Master Plan  
Juneau, Alaska

DATE: 2017-08-11  
JOB NUMBER: CBJ-17-01  
DRAWN BY: PDB  
CHECKED BY: CM

**Master Plan**  
SHEET #:  
**L100**

**1**  
**L100**  
**Park Master Plan**  
SCALE: 1"=40'-0" @ 22x34





**1**  
**L101** **Key Plan with Aerial Image**  
SCALE: 1"=40'-0" @ 22x34

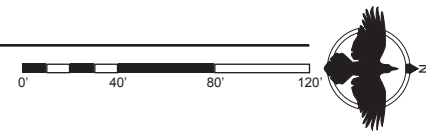



**Corvus Design**  
Landscape Architecture  
[www.corvus-design.com](http://www.corvus-design.com)  
Anchorage - 907.222.2859  
Juneau - 907.988.9000  
2506-B Fairbanks St, 99503  
119 Seward St, 99801  
AECC #1195



**CITY AND BOROUGH OF JUNEAU**  
ALASKA'S CAPITAL CITY  
ENGINEERING & PUBLIC WORKS

SEAL:

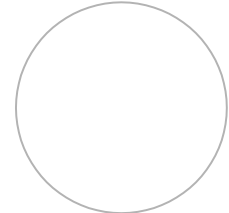

City and Borough of Juneau  
**Riverside Rotary Park**  
Master Plan  
Juneau, Alaska

If the above dimension does not measure one inch (1") exactly, this drawing will have been enlarged or reduced, affecting all labeled scales.

DATE: 2017-08-11  
JOB NUMBER: CBJ-17-01  
DRAWN BY: PDB  
CHECKED BY: CM

**Key Plan**

SHEET #:  
**L101**



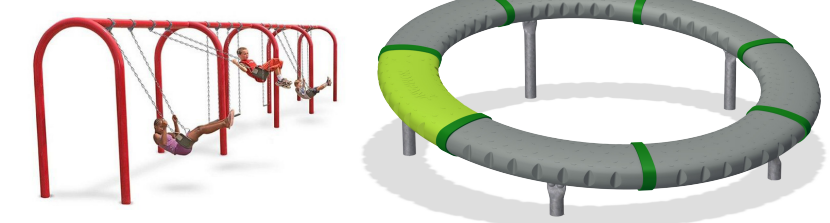
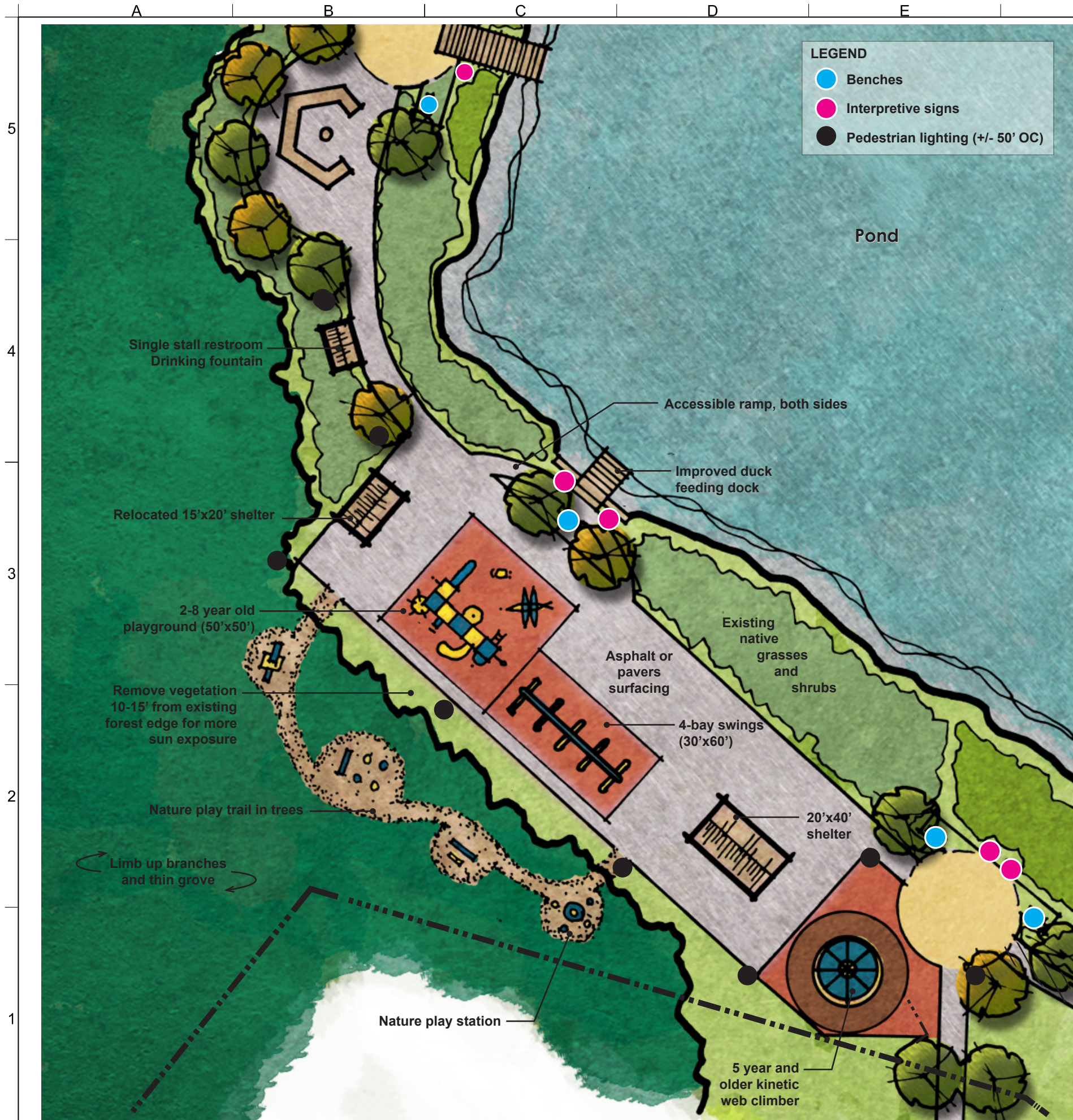

**1**  
**L102** **Master Plan Enlargement**

SCALE: 1"=20'-0" @ 22x34



**Corvus Design**  
Landscape Architecture  
www.corvus-design.com  
Anchorage - 907.222.2859  
2506-B Fairbanks St, 99503  
Juneau - 907.988.9000  
119 Seward St, 99801  
AEC #1195

**CITY AND BOROUGH OF JUNEAU**  
ALASKA'S CAPITAL CITY  
ENGINEERING & PUBLIC WORKS

SEAL:

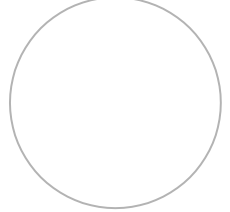

**City and Borough of Juneau**  
**Riverside Rotary Park**  
**Master Plan**  
**Juneau, Alaska**

DATE: 2017-08-11  
JOB NUMBER: CBJ-17-01  
DRAWN BY: PDB  
CHECKED BY: CM  
**Enlarged Master Plan**

SHEET #:  
**L102**